

The Drawing and its contents are to be kept secret from third parties, particularly competitors. The drawing and documents which go with it are not to be duplicated either in local or extract, or used in other documentation without express approval (§15 and §18 UrHG - §1 and §18 UWG). A reservation of rights in accordance with §12 PatG is declared for the event that a patent is granted.

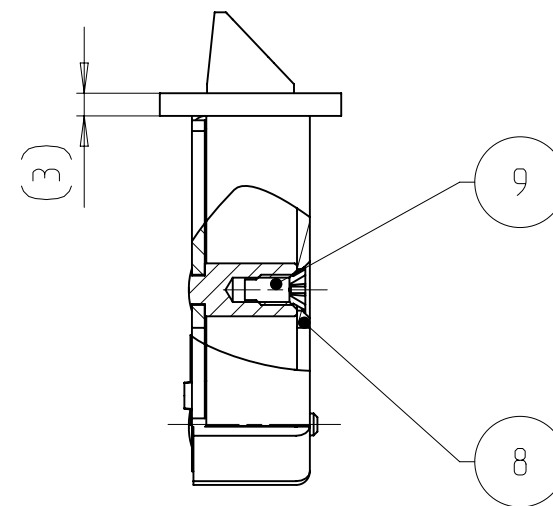
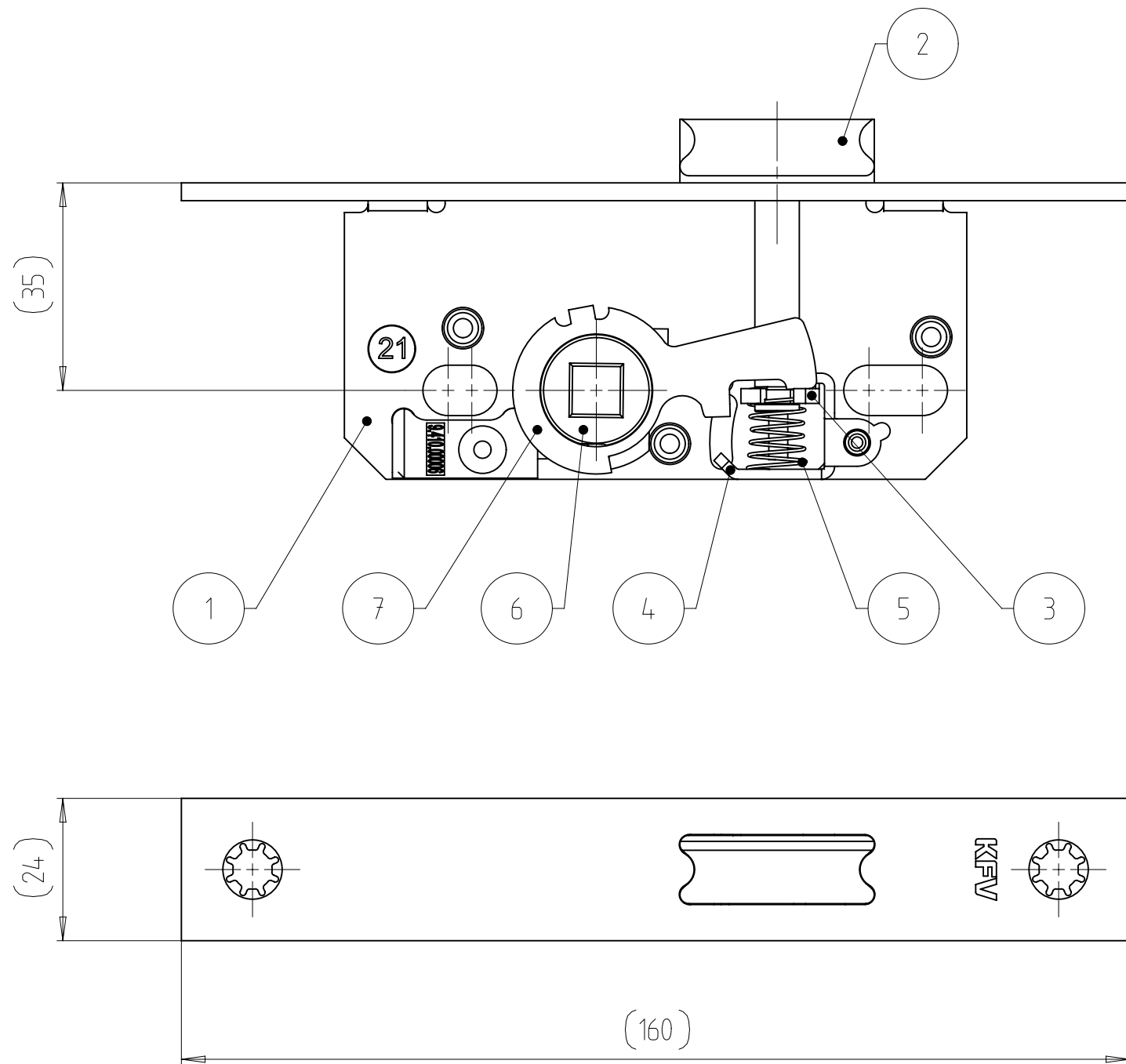

Pos	Benennung	Stck	PDM-Nr.	Teil	Bemerk
9	908_Schraube	3	9.741.00005	000	
8	Decke	1	9.020.00066	035	
7	Wechselarm	1	9.081.00002	000	
6	Nuss Vkt. 8,1	1	9.070.00020	000	
5	Druckfeder	1	9.700.00006	000	SR-TEIL
4	Fallenumsteller	1	9.066.00006	000	
3	Plattstift	1	9.100.00004	000	
2	Fallenkopf 13 mit Eingiessteil	1	7.061.00090	035	
1	Blech kplt.	1	7.012.00048	035	

Qty.	Type of Modification	Uebernahme nach UG		ANT	Drawn	Approved	Date	
				EK1-21514.01	Czernecki		27.04.2022	
Volume /mm³	Weight/g	Material-No.	Item-No.	Tool-No.				
			RES 68					
		Tolerance	Part-Description					
		ISO2768mK	RES 68					
Scale		Additional Notice		35 Dorn				
1 : 1								
Drawn	Velten			Document No.	Doc. Part No.	Revision	Status	
Date	05.04.2004			3.0068.0004	035	25	20	
Appr.	Asbeck			Replacement for :		Test procedure		Size
Date	01.12.2005			Replaced by :				A3